

Hand Trucks Built to Exceed Any Demand

1.5 inch poly strap and buckle system, lab tested to 1200 psi., are standard. Cylinder Locking Rings are optional.

Each cylinder is held tightly in place with individual straps or clamps. Cinch strap system adjusts to 4 to 12 inch diameter cylinders. Clamp system adjusts for 6 to 10 inch diameter cylinders.

All brackets use steel reinforced vinyl edge guard, protecting the cylinders and helping grip them tightly in place

Wheel styles available:
8-inch semi pneumatic, 8 inch all steel, 10.5-inch fully pneumatic or 16-inch fully pneumatic wheels. All main wheels have steel hubs, ball bearings and quick release axle clips.

All models are available with wide-set dual rear caster assembly for safe, stable cylinder transport. All fold flat against rear of hand truck for storage in the upright position

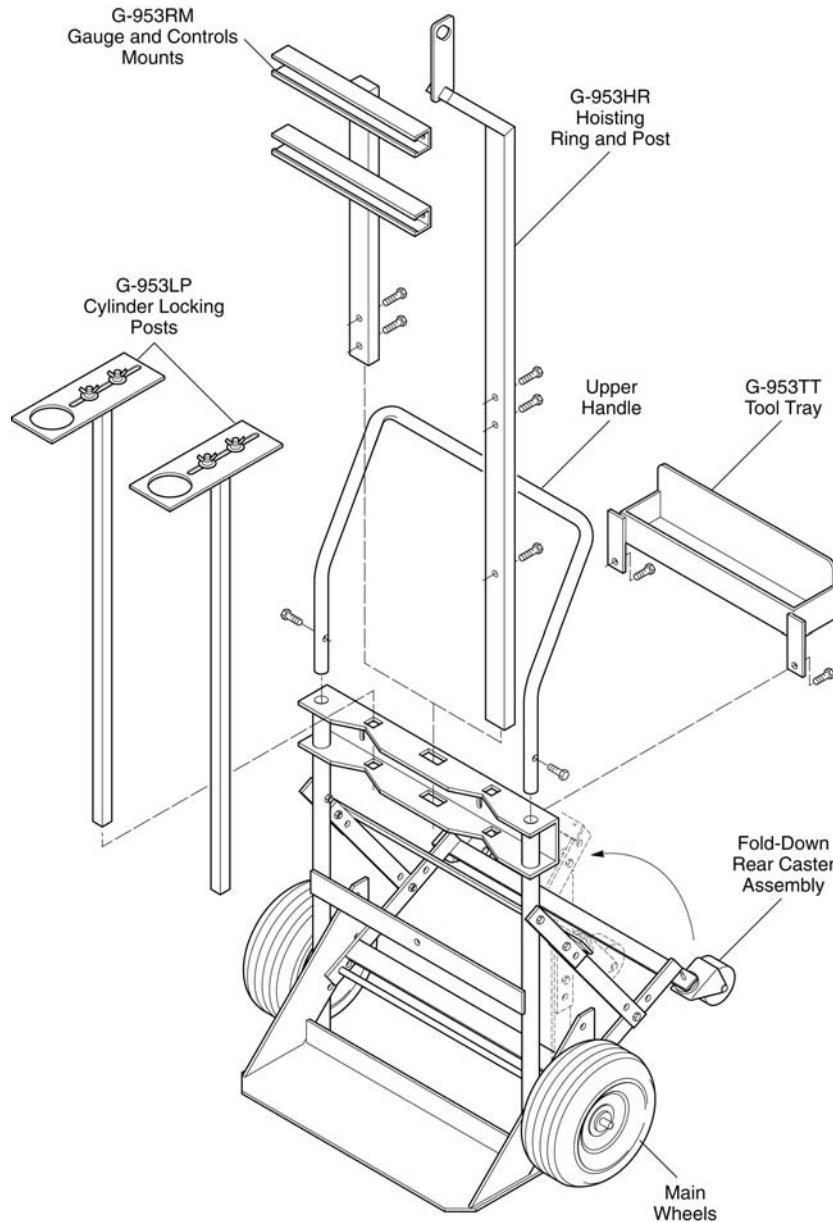

Heavy Duty Construction throughout. 7, 10 and 11 gauge steel plate, 14 gauge round tube, fully welded and sealed with powder paint

Upper handle detaches for shipment. Most models can ship UPS.

Zero lift height loading. All First Safety hand trucks are perimeter braced to enable the footplates to rest flat against the floor. Lifting to load and unload cylinders is eliminated

Select the features that meet your cylinder transport needs. Cylinder locking posts, hoisting ring and post system, regulator mounting tree, tool tray, and folding rear caster assembly available.



First Safety Corporation*PO Box 414 Wisconsin Rapids, WI 54495
715(424-0857*Fax (715)424-0857*www.firstsafety.com

Wheel and Caster Selections

Handtruck/Cart	8 Inch	8 Inch	8 inch	10.5 Inch	16 Inch	3 Inch	4 Inch	5 Inch
Part Number	Semipneumatic	Poly Alloy	Steel Wheel	Pneumatic	Pneumatic	Casters	Casters	Casters
G-430							X	
G-630							X	
G-901	X							
G-902				X				
G-902 SS		X						
G-903	X					X		
G-904				X		X		
G-905	X							
G-906				X				
G-907	X					X		
G-908				X		X		
G-2000				X		X		
G-2010				X		X		
G-952				X				
G-953				X		X		
G-955				X				
G-956				X				
G-957				X				
G-958				X				
G-959				X				
G-943				X		X		
G-944				X		X		
G-945				X		X		
G-950				X		X		
G-954				X		X		
G-949				X		X		
G-991					X			
G-973					X			X
G-975					X			
G-976					X			
G-977					X			
G-978					X			
G-987			X					
G-990					X			
G-993					X			X
G-994					X			X
G-995					X			X
G-970					X			X
G-974					X			X
G-999					X			X